

**FIBER OPTIC TERMINI SIZES 16 & 12**

Fiber optic contacts are called Termini. Fiber optic termini are shown in the table below. Tooling used to connect the fiber optic cable to the termini is available. For more information, contact your nearest RADIALL representative.



CONTACT SIZE	VERSION	CABLE DIA.	FIBER SIZE	PIN	SOCKET	INS/EXT TOOL
16	CERAMIC	.059 (1.5)	50/125	<b>F724005000</b>	<b>F724104000</b>	<b>282929/282892</b>
			100/140	<b>F724002000</b>	<b>F724101000</b>	
	METAL	.071 (1.8)	HCS200	<b>F724041000</b>	<b>F724140000</b>	
			HCS400	<b>F724045000</b>	<b>F724144000</b>	
12		.098 (2.5)	HCS200/280	<b>F724241200</b>	<b>F724341200</b>	<b>EXT 282 945</b>

**SIZES 22 & 20HD PC TAIL CONTACTS**

CONTACT SIZE	CONTACT ARRANGEMENT	PIN	SOCKET	EXTRAC-TION TOOL	DIMENSIONS					
					A	B	C dia	D	E	
22	106	/	<b>616379</b>	<b>282890</b>	.240/.209 (6.1/5.3)	.256 (6.5)	.023 (0.6)	.994/1.013 (25.25/25.75)	.061/.069 (1.55/1.75)	
			<b>616303</b>		.567/.535 (14.4/13.6)	.370 (9.4)				
			<b>616306*</b>		.232/.263 (5.9/6.7)					
	36C7 for pin contacts	<b>616206*</b>	/							
	36C7 for socket con-tacts	/	<b>616306</b>			.032/.004 (0.82/0.10)		.149 (3.8)	/	.293/.309 (7.85/7.44)
		/	<b>616303</b>			.157/.130 (4.00/3.30)			1.122/1.108 (28.50/28.15)	/
20HD	40-45-57-32C2-32C4-40C1	<b>616216*</b>	/	<b>282891</b>	.259/.299 (6.6/7.6)	/	.031 (0.8)	1.23/1.25 (31.25/31.75)	.293/.305 (7.45/7.75)	
	67-33C4				.248/.287 (6.3/7.3)					
	40-45-57-32C2-32C4-40C1	<b>616223</b>	<b>616323*</b>			.138/.169 (3.5/4.3)	.126 (3.2)	.023 (0.6)		
	67-33C4					.126/.157 (3.2/4)				

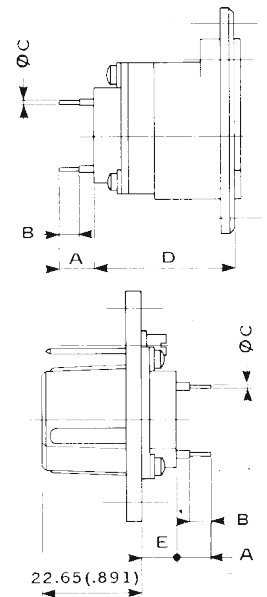

Connectors delivered in the "Y" termination style will be fitted with contacts marked with "\*" (see above table). If you want to use an other kind of pc tail contact, use termination style "x" when ordering the connector and order contacts separately.

**SIZES 22 & 20HD WIRE WRAP CONTACTS**

CONTACT SIZE	AWG	CONTACT ARRANGEMENT	PIN	SOCKET	INS. TOOL	DIMENSIONS			
						A	B	C	
22	26 28 30	106	<b>610203</b> (2 wrap levels)	<b>610303</b> (2 wrap levels)	<b>282948</b>	.393/.433 (10/11)	.994/1.013 (25.25/25.75)	.061/.069 (1.55/1.75)	
			<b>610204</b> (3 wrap levels)	<b>610304</b> (3 wrap levels)		.492/.531 (12.5/13.5)			
20HD	26 28 30	40-45-57 32C2-32C4-40C1	<b>610214</b> (2 wrap levels)	<b>610314</b> (2 wrap levels)			.405/.445 (10.3/11.3)	1.230/1.250 (31.25/31.75)	.293/.305 (7.45/7.75)
		67-33C4					.387/.431 (9.85/10.95)		

