

This document is the property of Amphenol Corporation and is delivered on the understanding that it is for the sole use of the recipient. It is not to be reproduced, stored in a retrieval system, or transmitted in any form or by any means, electronic, mechanical, photocopying, recording, or by any information storage and retrieval system, without the prior consent of Amphenol Corporation. Amphenol Corporation reserves the right to change the design of its products without notice and without liability. Amphenol Corporation does not warrant the performance of its products for any specific application. Amphenol Corporation is not responsible for any damage or injury resulting from the use of its products. Amphenol Corporation is not responsible for any claims, damages, or liabilities, including reasonable attorneys' fees, arising from the use of its products. Amphenol Corporation is not responsible for any claims, damages, or liabilities, including reasonable attorneys' fees, arising from the use of its products. Amphenol Corporation is not responsible for any claims, damages, or liabilities, including reasonable attorneys' fees, arising from the use of its products.

# Customer drawing

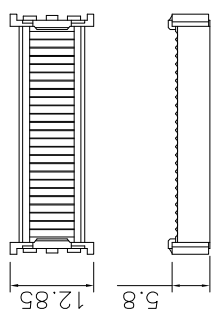

Cover

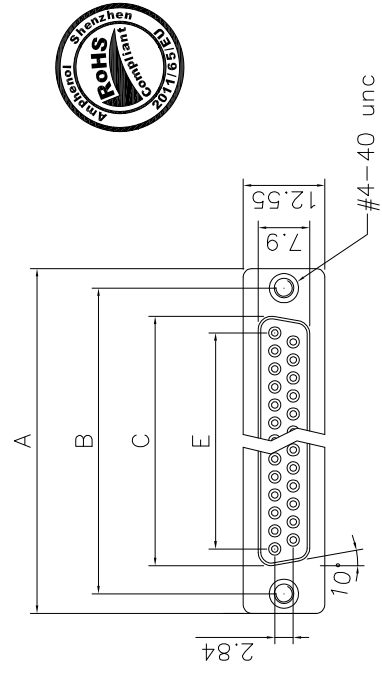
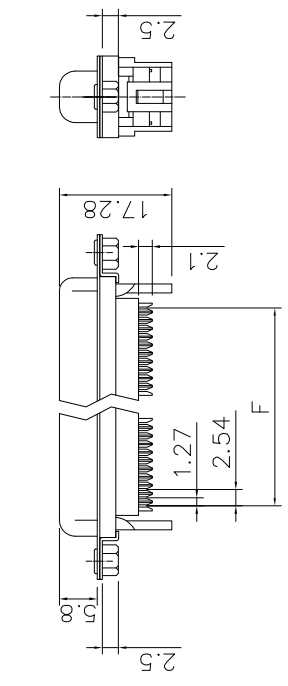

Strain Relief

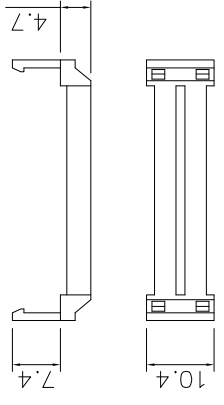

Dimensions

Positions	A	B	C	E	F
9	30.81	24.99	16.33	11.08	10.16
15	39.20	33.30	24.70	19.39	17.78
25	53.05	47.04	38.40	33.24	30.48
37	69.40	63.50	54.80	49.86	45.72

REVISIONS			
SYM	ECN	DESCRIPTION	DATE
1	HK--	First Release Drawing	10/29/08
2	HK--	Update the Drawing	01/21/15

## D-SUB TECHNICAL DATA

**SHELL :** Steel, 100u" Tin Over 50u" min nickel over 50u" min Copper  
**BODY :** Glass-Filled Thermoplastic PBT,UL94V-0,Black  
**CONTACTS :** Copper alloy  
 30u" gold over 50u" nickel on mating area  
 100u" tin over 50u" nickel on termination area  
**Rear Nut :** Brass, Nickel Plated.  
**ELECTRICAL :** Voltage rating 250 VAC/Rms 60Hz  
 Current Rating .3 AMP  
 Withstanding Voltage >1000 VAC Rms  
 Insulation resistance >1000 M Ohms  
 Contact resistance 20 mOhms max  
**MARKING :** Amphenol---(Series No.)  
 Commercial reference  
 Manufacturing date

## PRODUCT CODE

# L 17D X FR D A XX S C309

- L: RoHS Compliance
- Shell Size:E,A,B,C
- Flat ribbon cable type
- D = rear insert 4-40
- Gold plating: 30u"
- Contact type: S=Socket
- Configuration: 09,15,25,37
- Type: A=Front metal shell

UNLESS OTHERWISE SPECIFIED		APPROVAL	DATE
TOLERANCES	METRIC	DRAWN	01/21/15
.X	0.50	CHECKED	01/21/15
.XX	0.20	CHECKED	
FRACTIONS +/-			
ANGLES +/-	5°		
FOR MATERIALS AND FINISHES			
REMOVE SHARP EDGES			
DIMENSIONS			
INCHES			
MM			
ANGLE OF PROJECTION			

Amphenol	
Amphenol East Asia Limited	
TITLE IDC Flat Cable D-SUB Series	
SIZE	DRAWING NO.
A4	L17DXFRDAXXC309
SCALE	NONE
	SHEET 1 OF 1
REV.	2